



TYNDALE
Kitchens & Interiors

Hawkesbury Village Hall committee
C/O Mrs S White
9 Hunters Mead
Hawkesbury Upton
S Glos

30 June, 2008

Dear Sarah,

RE: **HALL KITCHEN AND SERVERY REPLACEMENT**

Further to our recent conversation, I am pleased to be able to provide some initial designs and budgets for the replacement of the kitchen and servery areas.

My designs are based on flat white doors and drawers, which not only look clean but are also easy to maintain. I have included inset stainless steel sinks, one 2 bowl with drainer and one 1 1/2 bowl and drainer, I have also allowed for the existing dishwasher and range to remain as they are.

I have included laminate worktops in the costings with an extra figure should you wish to upgrade to a solid surface similar to the bar area

I am more than happy to provide samples of doors and worktops should these be required

• To: Replacement of Hall kitchen units as per plan supplied Includes removal & disposal of existing, supply and fit of new	£5895.27
• To: Extra for Granite work surface (TBC)	£1800.00
• To: Extra for solid surface as per the bar (TBC)	£2000.00
• To: Replacement of Hall Servery units as per the plan supplied Includes removal & disposal of existing, supply and fit of new	£1924.59
• To: Extra for granite work surface(TBC)	£558.00
• To: Extra for solid surface as per the bar (TBC)	£600.00

The above prices are inclusive of VAT @ (17.5%) and will be subject to any price alterations made by suppliers prior to order.

No allowance has been made for any lighting, locks on cabinets or flooring, but I will be happy to provide quotes for these once I know more of your requirements and quantities.

Should you wish to discuss any item further, please do not hesitate to contact me

Yours sincerely

M J Weaver

Tyndale Cottage, Sandpits Lane, Hawkesbury Upton, South Gloucestershire, GL9 1BD
T 01454 238770 M 07974 712083 E mweaver@fsmail.net
Company Registration No: 6476666 Vat No: 933073144





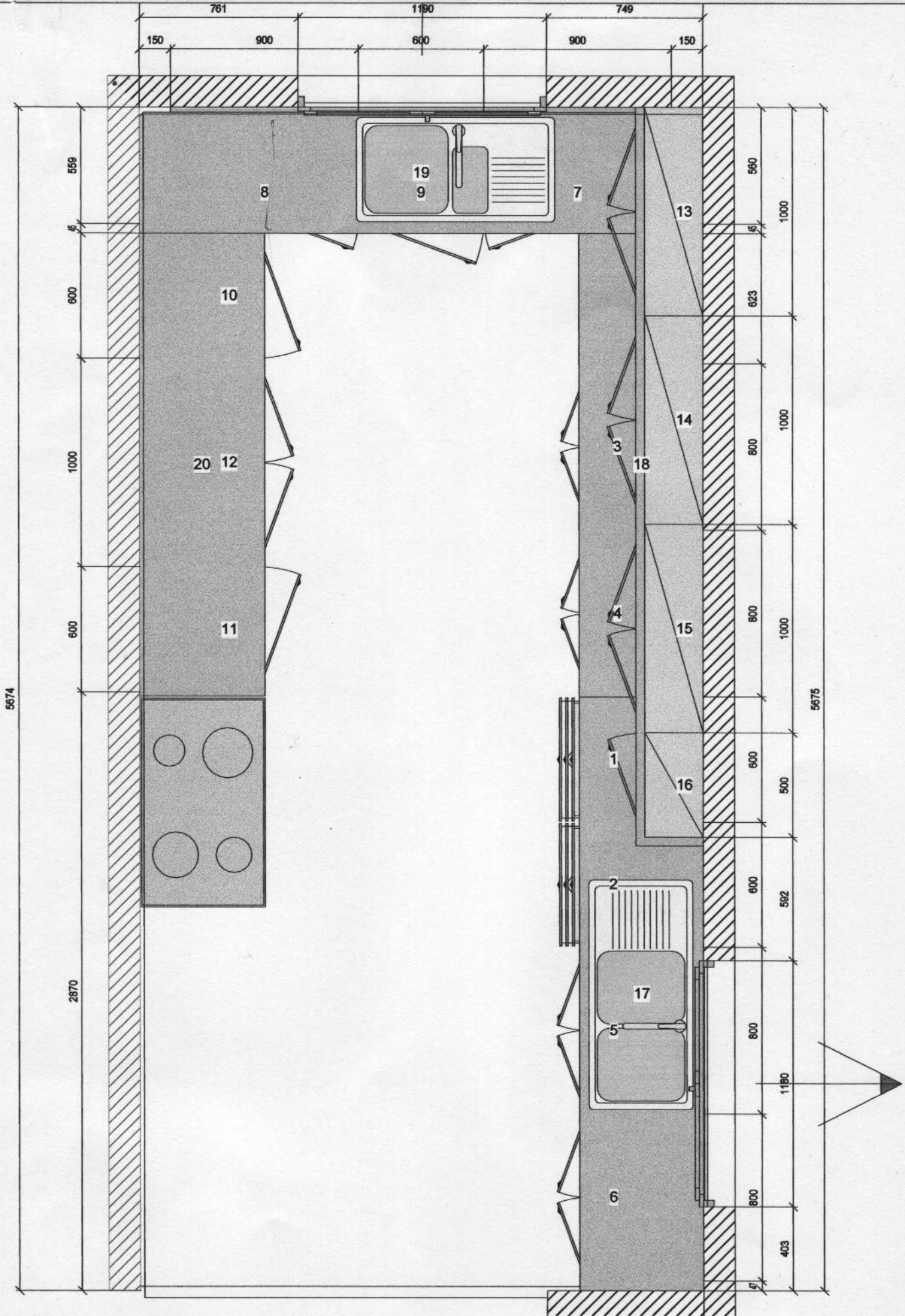

www.kitchendraw.com

Scale : 1 / 23.93

MARTIN - WRAPER

28/06/2008

486628CC_0006_01.scn



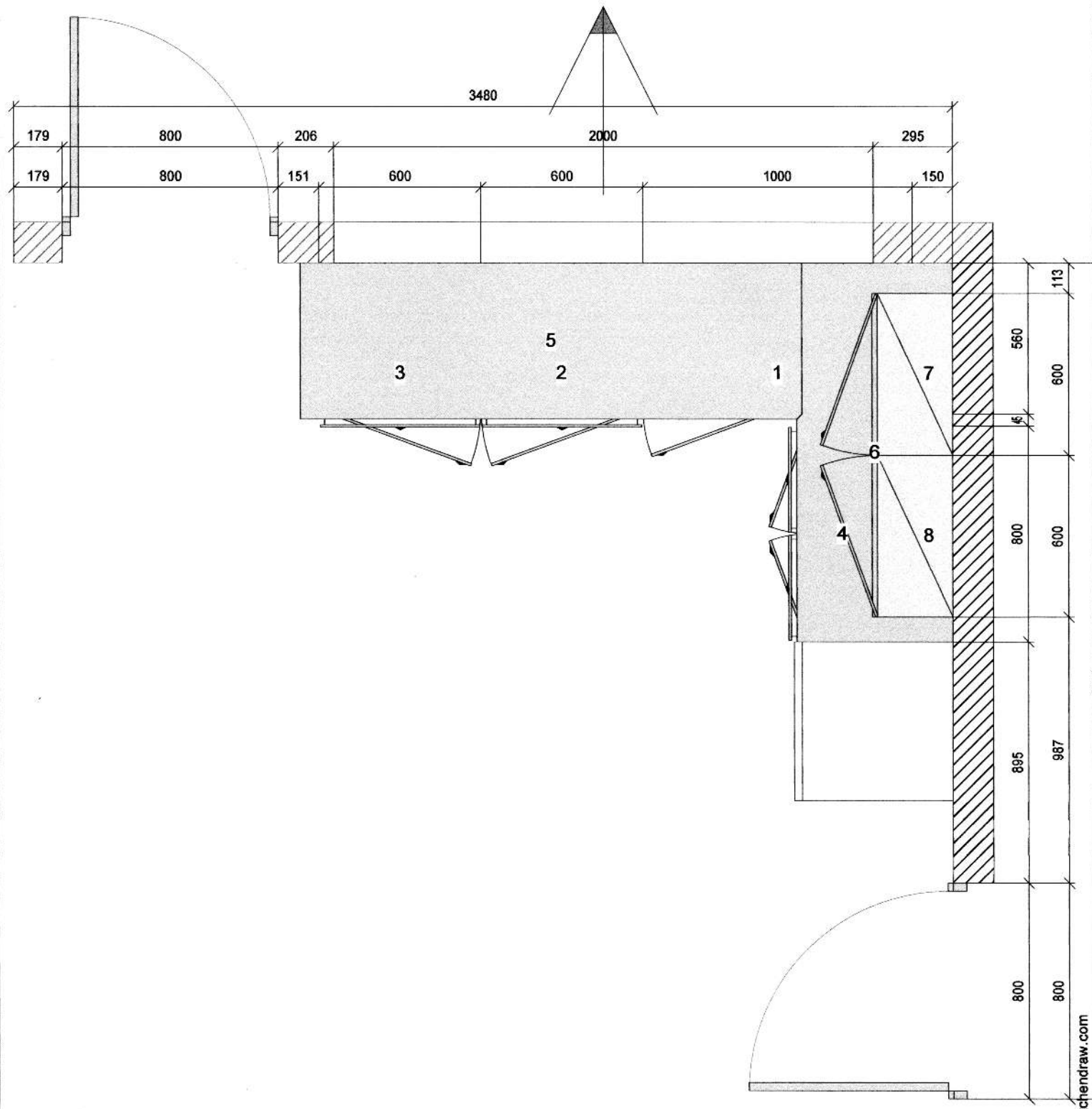

Scale : 1 / 20

MARTIN - WRAPUP

28/06/2008

48665171_0007_01.scn